



JECTOR EK-RT100B

Storage Space Assembly Instruction

Contents :
 steel plate*1、wood plank * 1、
 10 feet (3 meters) power cord、
 power strip*1、electrical outlet*1、
 key、screws

Screw list :

 (A)*23  (B)*5

 (C)*1

 (E)*6

PS.
 Please use tools for assembly :
 screwdriver、7mm socket、
 steel hammer

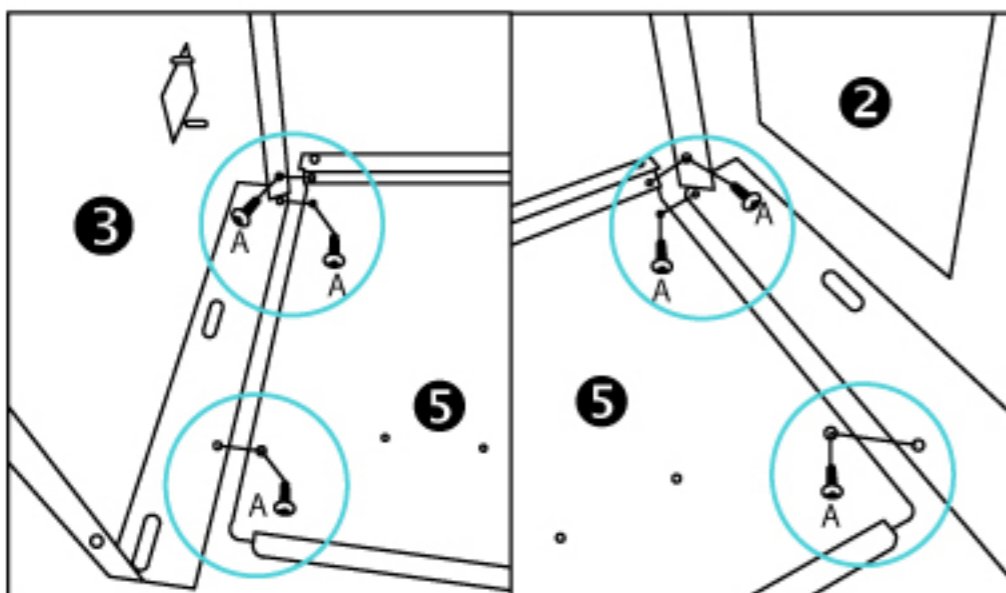
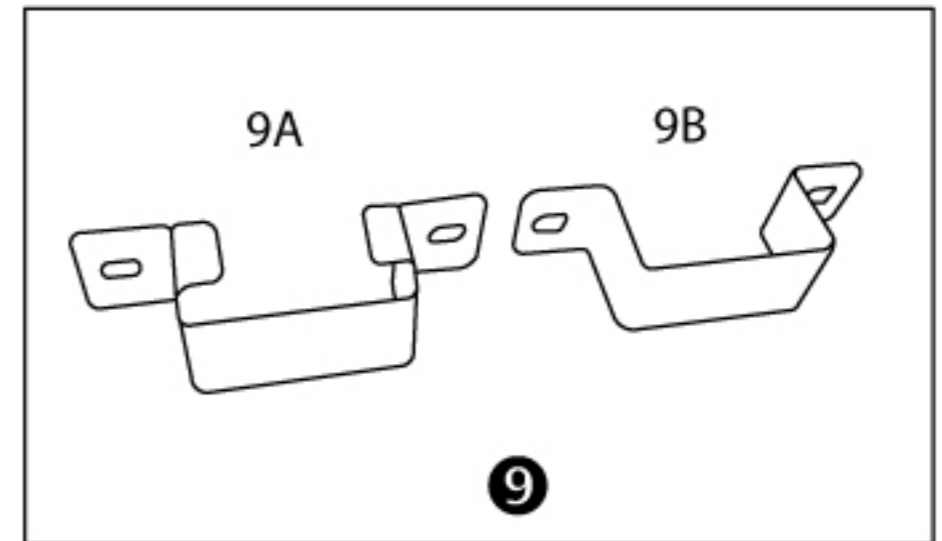
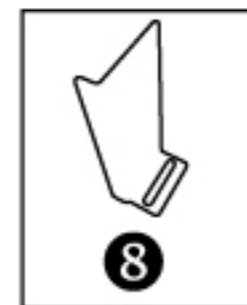
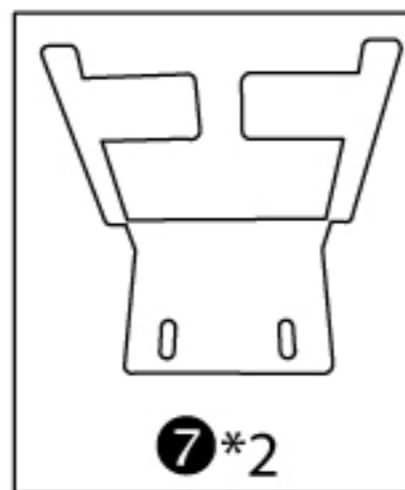
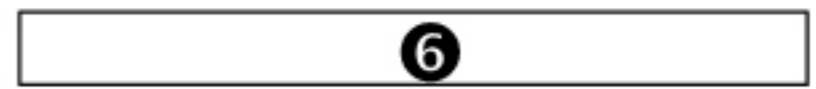
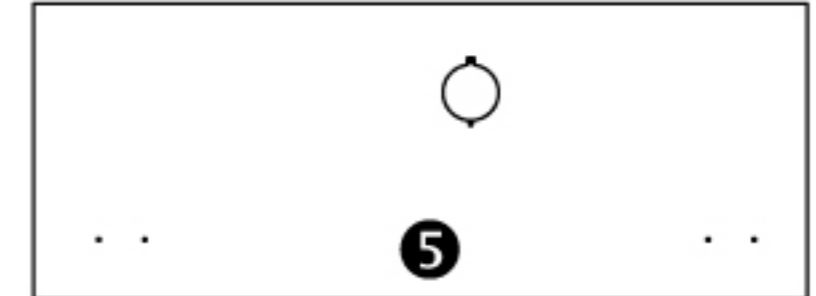
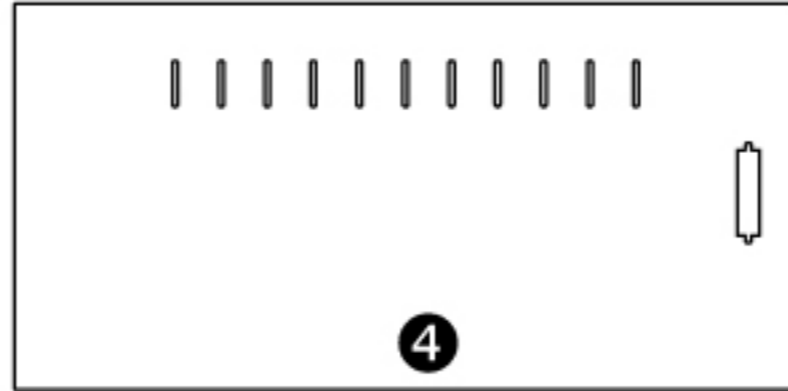
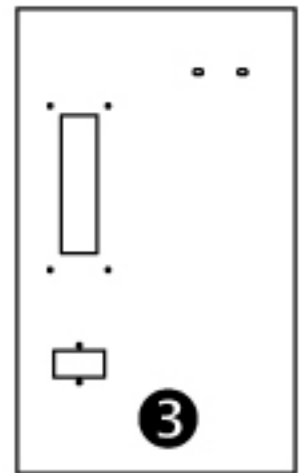
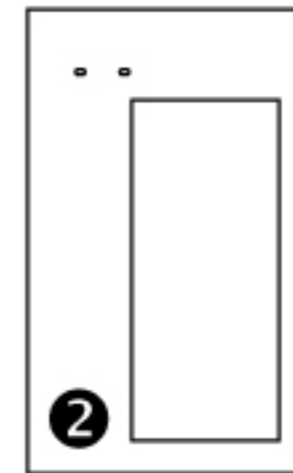
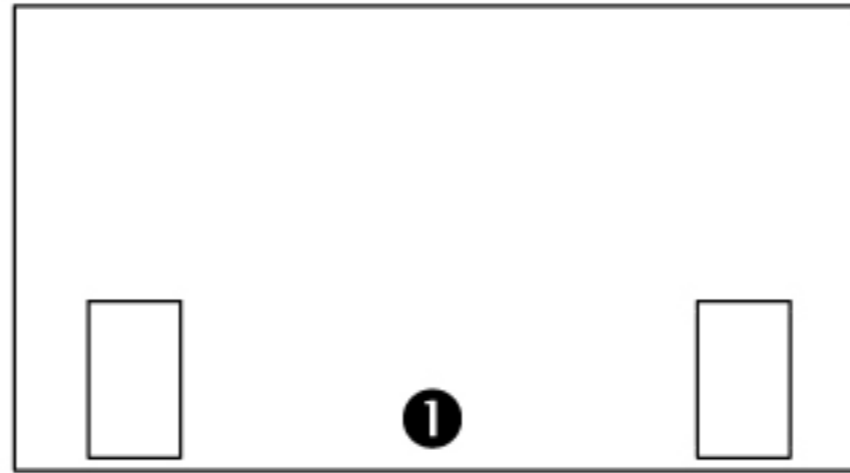

1 Lock screw A from bottom to top

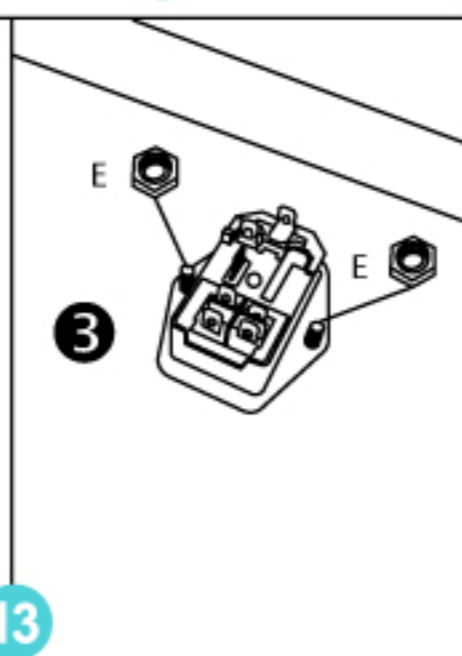
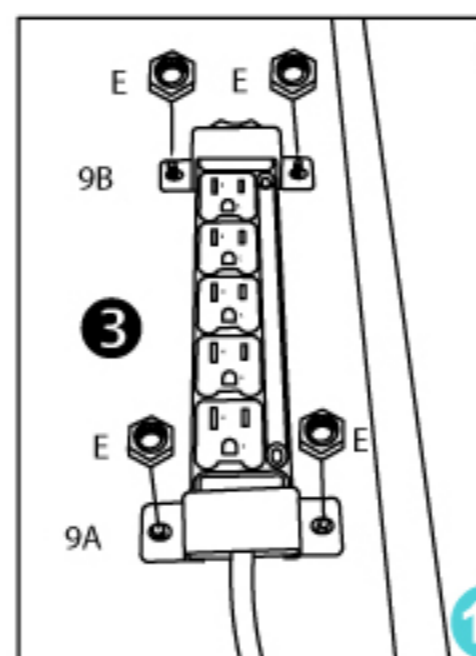
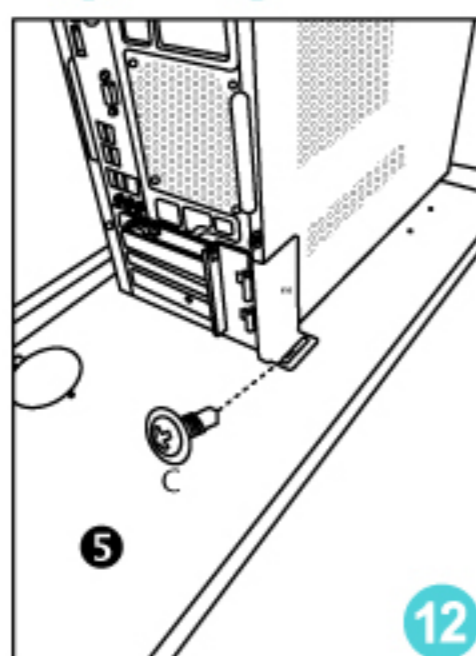
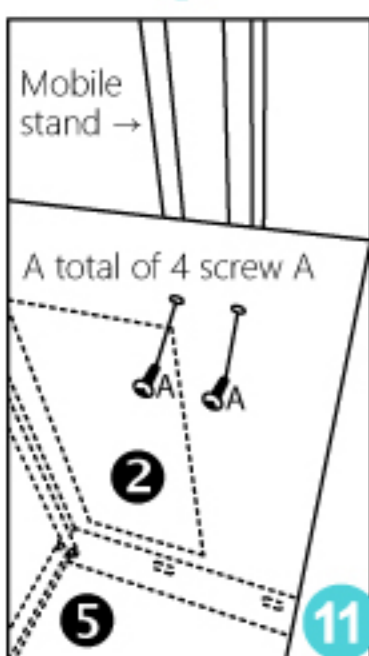
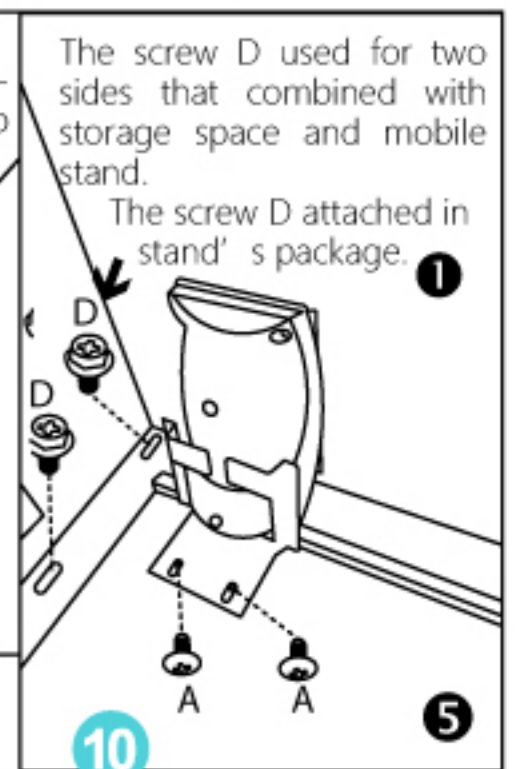
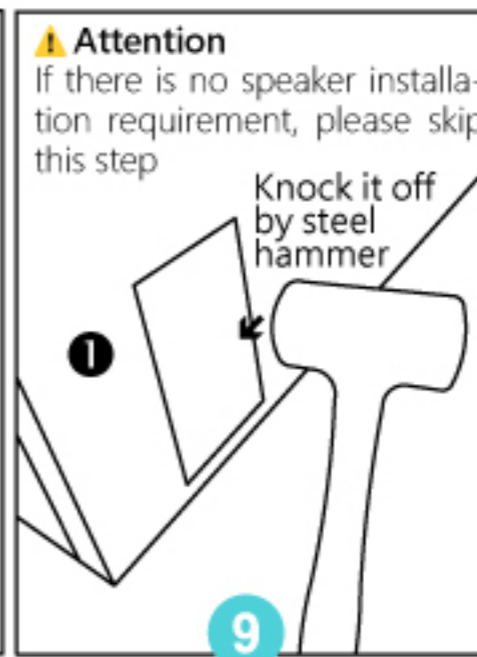
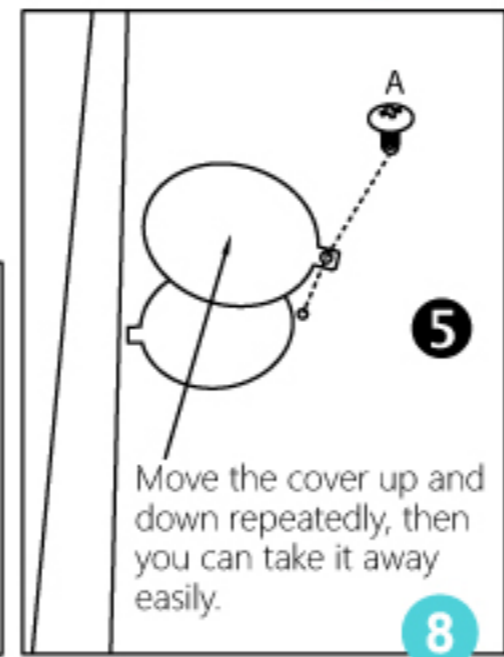
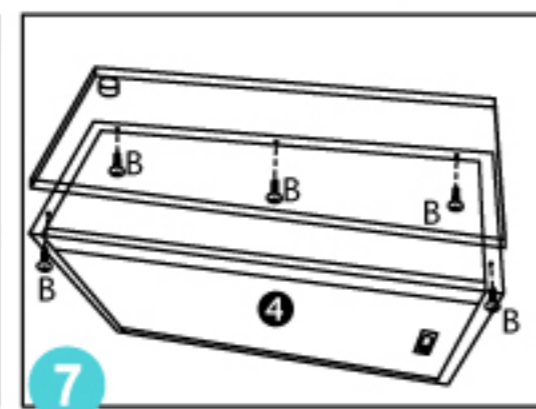
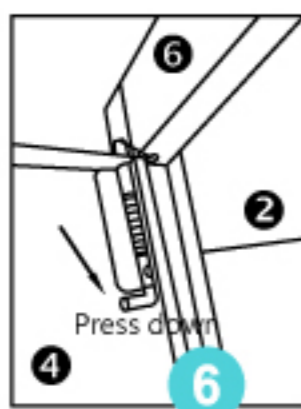
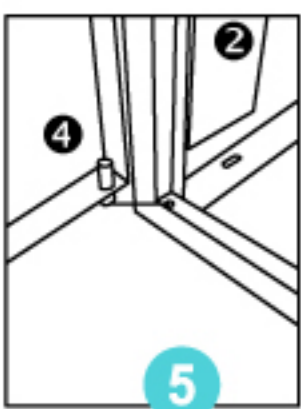
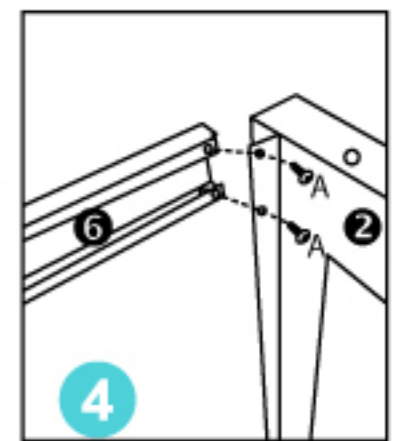
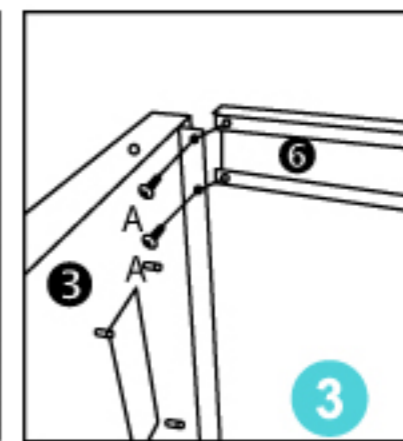
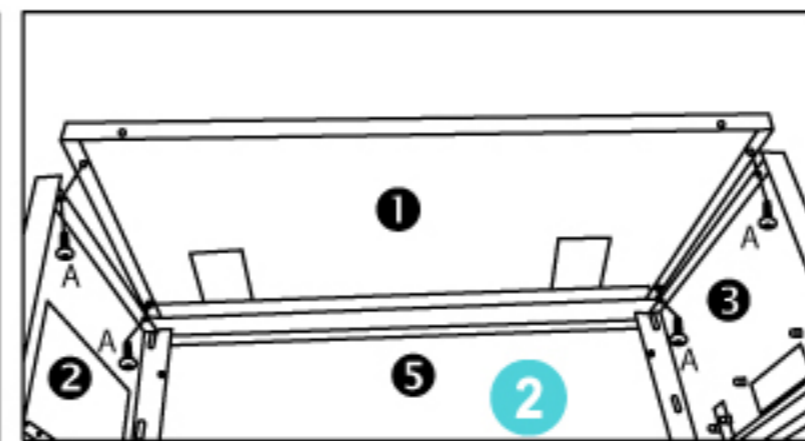

Attention
 If there is no speaker installation requirement, please skip this step

Knock it off by steel hammer

Move the cover up and down repeatedly, then you can take it away easily.

The screw D used for two sides that combined with storage space and mobile stand.

The screw D attached in stand's package.



JECTOR EK-RT100

Mobile Stand Assembly Instruction

Contents :

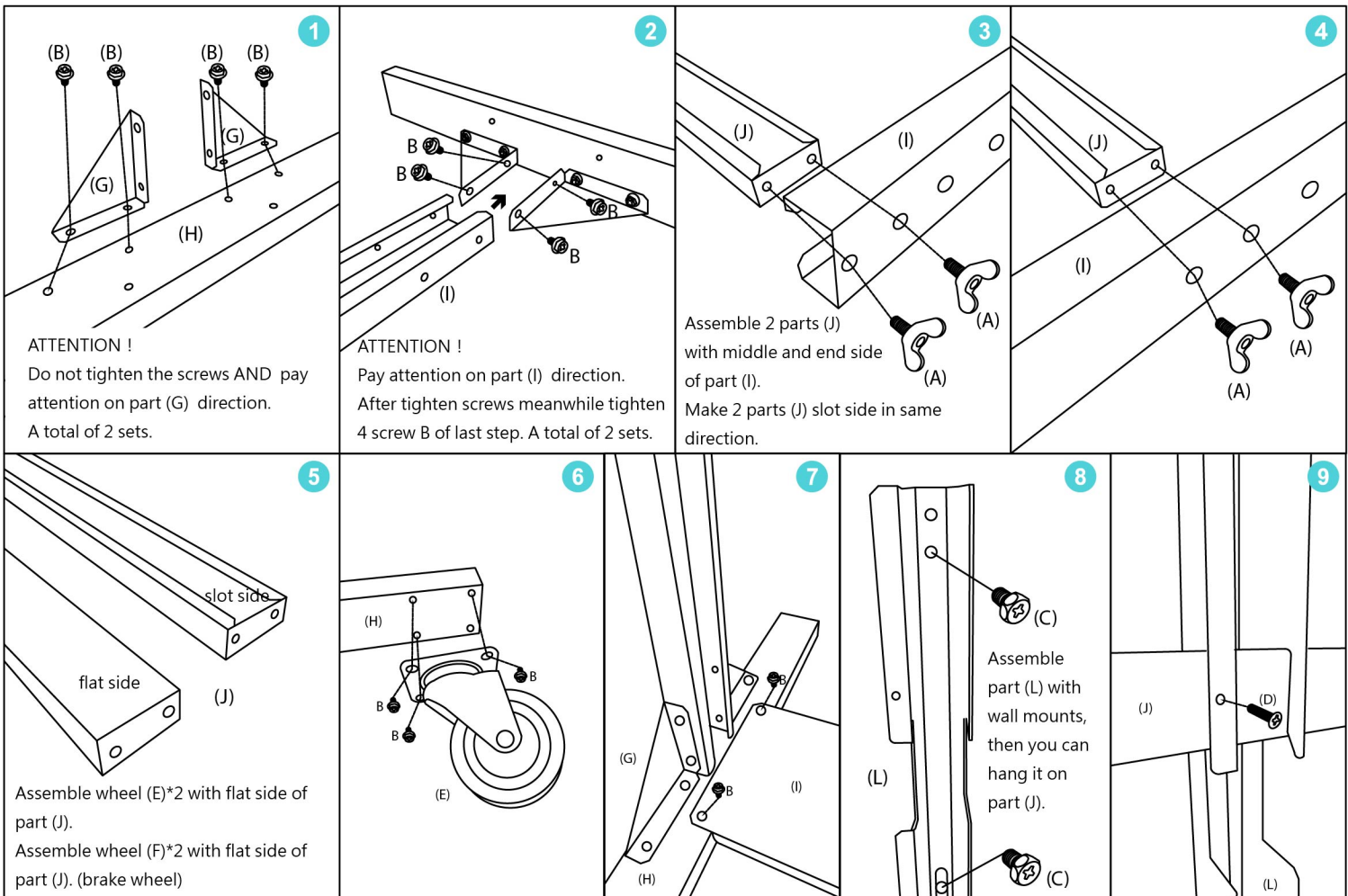
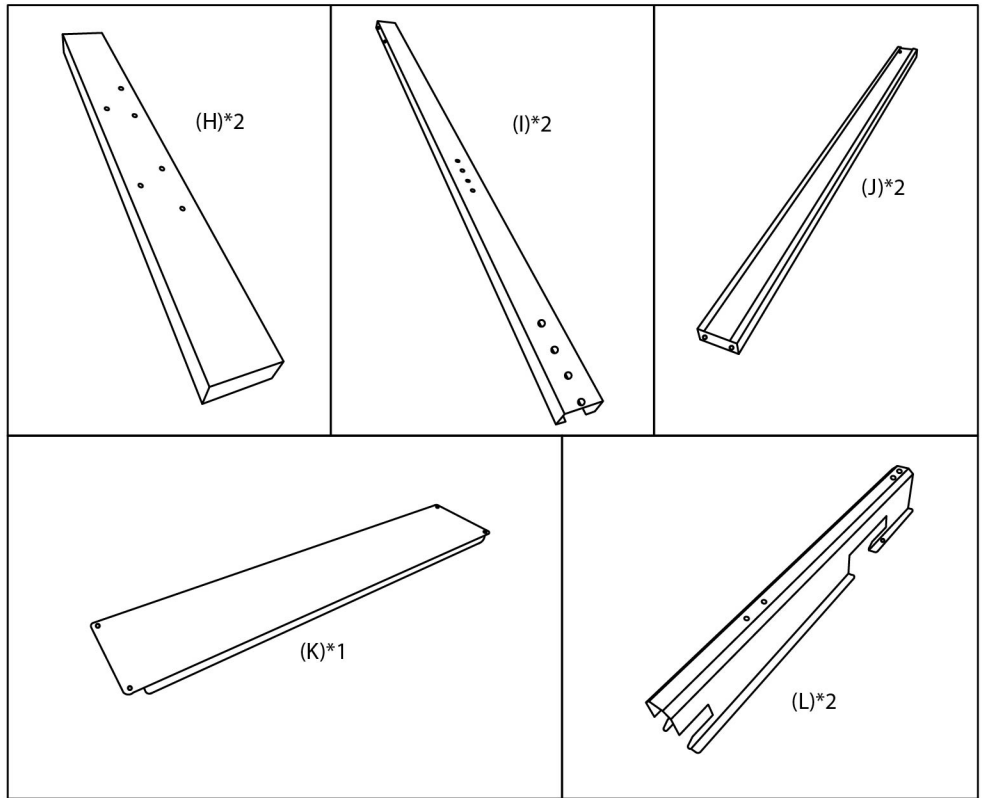
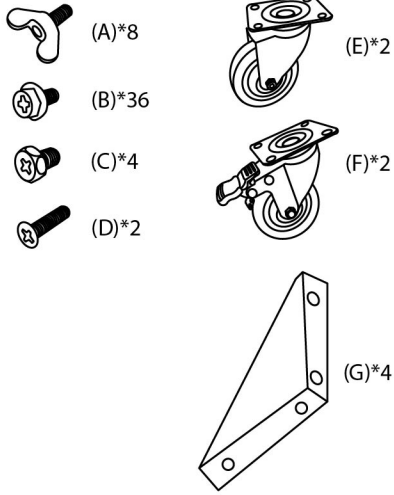

JECTOR Digital Corporation

5F-2, No.268, Liancheng Rd,Zhonghe Dist.,
 New Taipei City 235038,Taiwan (R.O.C.)
 +886 282273311 +886 282273322

